

**PRINCESS YACHTS F55 • 2019**

Ref:PB2152

PRICE: £1,449,000 INC VAT



OPEN TO PART EXCHANGE • PRINCESS TECHNICAL ORIENTATION INCLUDED

PROFESSIONAL PHOTOGRAPHY, VIRTUAL TOUR AND BROKER WALK-THROUGH VIDEO AVAILABLE

Twin Volvo D13-900 (2x 900mhp) diesel engines • White hull • Walnut interior wood satin finish • Teak laid flybridge deck, side decks, foredeck and coach walkthrough • Allure pack update • Onan 17.5Kw generator • Full Navigation pack • Seakeeper Gyro stabiliser (NG9) • Volvo joystick system • Bow and stern thrusters • Air conditioning • Continental 220V/240V Sockets • Electro-hydraulic telescopic passerelle • Hydraulic platform • Foldaway swimming ladder • Electrically operated saloon dining/coffee table • Starboard guest cabin with double berth conversion • 49" UHD TV • Fusion systems and speakers in saloon, owners cabin and flybridge • Williams Jet Tender available by separate negotiation

PLEASE CONTACT US FOR MORE INFORMATION ON THIS PRINCESS F55 FLYBRIDGE MOTOR YACHT FOR SALE

- Established over 40 years.
- Central agency for over 90 brokerage yachts for immediate delivery.
- Specialists in international delivery and the sourcing of yacht taxation advice.
- Access to the global Princess support network.

# PRINCESS YACHTS F55

## SPECIFICATION

### BUILDER/DESIGNER

Year: 2019  
Construction: GRP

### ENGINES

No. of Engines: 2  
Make: Volvo  
Model: D13-900  
Fuel Type: Diesel  
Hours: 205  
Total Power: 1800 hp

### ACCOMODATION

Cabins: 3  
Heads: 2

### DIMENSIONS

Length: 17.65 m / 58 ft 10 in  
Beam: 4.88 m / 16 ft 0 in

### TANKS

Water: 1 x 507 l  
Fuel: 1 x 2290 l

### LOCATION

Mallorca, Spain

## INVENTORY

### HULL COLOUR

- White hull

### NAVIGATION EQUIPMENT

- Garmin remote control keypad (GRID) at the lower helm position
- Garmin (GMI 20 colour) 4" multifunction display at lower helm (for separate display and control of individual functions e.g. log and echo sounder)
- Second 16" colour multifunction display fitted at the upper helm
- Garmin remote control keypad (GRID) at the upper helm position
- Garmin GMI 20 4" multifunction display at upper helm

- Hold function docking facility, includes a variable speed stern thruster with Volvo engines & MAN engines where joystick is fitted
- Second 16" colour multifunction display fitted at lower helm position
- Garmin 424 XHD2 Radar with 48' open array (with display on standard 16" screen which allows separate or split displays with standard chartplotter and engine instrumentation)
- International VHF/RT
- Speed and distance log
- Echo sounder with alarm and autopilot
- Red night lighting

## DECK EQUIPMENT

- Teak laid Flybridge deck, side decks, foredeck and coach walkthrough
- Teak step nosings upgrade
- Stainless steel anchor in place of standard
- Additional 20m of 10mm Stainless steel anchor chain (Total = 60m)
- Foredeck freshwater anchor / deckwash system
- Reversible electric anchor winch with foredeck and helm position controls
- Stainless steel cleats, fairleads and handrails
- Rear cockpit vanity/sun screen
- Flydeck bimini top
- Exterior Lighting Upgrade Package - Includes Low level accent strip lights below flybridge wetbar and console, accent spots on transom, additional deck lights to side deck and foredeck area, pop up lanterns to flybridge forward dinette
- Electro-hydraulic Telesopic Passerelle 2.9m, with automatic handrails
- Transom platform to have electro-hydraulic raise/lower facility (450Kg) with pre-installed keys way chock plates
- Foldaway swimming ladder and hot and cold shower
- Two Electric Stern rope handling winches
- Cockpit cover - Grey Sunbrella Plus
  
- Flybridge - Grey Sunbrella Supreme
- Flybridge U-shaped seating area with folding teak table
- Flybridge forward L-shaped seating (converts to sunbed)
- Flybridge console and flybridge wetbar sprayed in Oyster Grey
- Storage lockers for fenders and ropes
- Foredeck seating and sunbathing area
- Wetbar including sink and stowage
  
- Williams Jet Tender available by separate negotiation

## SHIPS SYSTEMS

- Onan 17.5kW generator (150 hours - Jun 2024)
- Continental 220V/240V sockets
- Seakeeper Gyro stabiliser (NG9)
- Volvo joystick system
- Bow and stern thrusters with holding dock facility, variable speed
- Third station controls in cockpit including bow thrusters and emergency stop
- Power-assisted electric steering system with hydraulic back-up
- Reverse cycle air-conditioning/heating, suitable for temperatures up to 40c, with controls in all cabins and outlets in all areas (inc. bathrooms)
- Electric overboard discharge system in addition to standard manual system
- 24V 4x heavy duty batteries for engine starting
- 24V 4x heavy duty auxiliary batteries
- 60 amp battery charger charges both banks of batteries via an automatic switch charging system
- 4-bladed propellers in nickel aluminum bronze

- Electronic engine and gear shift controls
- Engine room extractor fans with electronic time delay

## INTERIOR FITOUT

- Walnut Interior wood, satin finish
- Galley floor in Walnut
- Timber floor to aft saloon area in Walnut
- Carpet in Quartz Linen
- Electrically operated saloon full size dining/coffee table. (Table reduces in length by 50% when folded with sliding mechanism to allow for use as a coffee table)
- Owners stateroom with large double bed with drawers below, vanity unit with pull out mirror and ensuite bathroom
- Overhead and individual berth lights in all cabins
- Forward cabin with large double bed with drawers below, dressing table and ensuite bathroom
- Starboard guest cabin with twin beds with conversion to double berth via sliding mechanism on inboard berth

## INTERIOR EQUIPMENT

- 4-zone ceramic hob
- Combination microwave/convection oven with grill
- Stainless-steel sink with mixer tap
- Dishwasher fitted in galley (slimline, 9 place setting)
- Full height fridge/freezer
- Washer dryer
- Mosquito screens for all opening portlights
- Penta China Table lamp to aft saloon sideboard (Gloss White finish)

## AUDIO VISUAL EQUIPMENT

- Deck Saloon - 49" UHD LED TV on a powered lift with Fusion MS-AV755 radio/DVD/MP3 player with Bluetooth connectivity)
- Master stateroom - Fusion SRX-400 Radio/Wifi/Bluetooth
- Flybridge - Fusion SRX-400 Radio/Wifi/Bluetooth with waterproof Fusion 6.5" speakers
- 2 x waterproof cockpit speakers with local control (linked to flybridge system)

## OWNER'S COMMENTS

- Jules is a lovely example of the Princess F55, which was built with a high specification
- One owner from new
- Fully serviced and prepared for the season
- Berthing for this year can be arranged in Palma, Mallorca
- Check out our professional photography and virtual tour to fully understand the benefits offered by this Princess F55 flybridge model

# PRINCESS YACHTS F55 INVENTORY

## DISCLAIMER

In this case we are acting as Brokers only.

The Vendor is not selling in the course of a business. Whilst every care has been taken in their preparation, the correctness of these particulars is not guaranteed. The particulars are intended only as a guide and they do not constitute a term of any contract. A prospective buyer is strongly advised to check the particulars and where appropriate at his own expense to employ a qualified Marine Surveyor to carry out a survey and/or to have an engine trial conducted which if conducted by us shall not imply any liability for such engine on our part.



# PRINCESS YACHTS F55 PHOTOS



EST 1964

OUR KNOWLEDGE IS YOUR LUXURY

**> OPEN TO PART EXCHANGE**

WE CAN HELP SPEED UP THE SALE THROUGH OUR OFFER TO UNDERWRITE A PART-EXCHANGE AGAINST THE BROKERAGE YACHT

**> PRINCESS TECHNICAL ORIENTATION INCLUDED**

AT NO ADDITIONAL COST, REGARDLESS OF WHERE THIS YACHT IS LOCATED, WE OFFER A COMPREHENSIVE TECHNICAL INTRODUCTION TO YOUR PURCHASE

**> PROFESSIONAL PHOTOGRAPHY, VIDEO & 3D TOUR AVAILABLE**

VIEW IMAGERY, VIDEO AND A 3D TOUR/WALKTHROUGH OF THIS YACHT ONLINE



[brokerage@princess.co.uk](mailto:brokerage@princess.co.uk)

+44 (0)1489 557755

[www.princessmotoryachtsales.com](http://www.princessmotoryachtsales.com)



Princess F55 For Sale

## PRINCESS YACHTS F55 PHOTOS



Princess F55 For Sale



Princess F55 For Sale



# PRINCESS YACHTS F55 PHOTOS



Princess F55 For Sale



Princess F55 For Sale



Princess F55 For Sale



Princess F55 For Sale



Princess F55 For Sale



Princess F55 For Sale





Princess F55 For Sale



Princess F55 For Sale



Princess F55 For Sale



Princess F55 For Sale



Princess F55 For Sale



Princess F55 For Sale





Princess F55 For Sale



Princess F55 For Sale



Princess F55 For Sale



Princess F55 For Sale



Princess F55 For Sale



Princess F55 For Sale





Princess F55 For Sale



Princess F55 For Sale



Princess F55 For Sale



Princess F55 For Sale



Princess F55 For Sale



Princess F55 For Sale





Princess F55 For Sale



Princess F55 For Sale



Princess F55 For Sale



Princess F55 For Sale



Princess F55 For Sale



Princess F55 For Sale





Princess F55 For Sale



Princess F55 For Sale



Princess F55 For Sale



Princess F55 For Sale



Princess F55 For Sale



Princess F55 For Sale





Princess F55 For Sale



Princess F55 For Sale



Princess F55 For Sale



Princess F55 For Sale



Princess F55 For Sale



Princess F55 For Sale



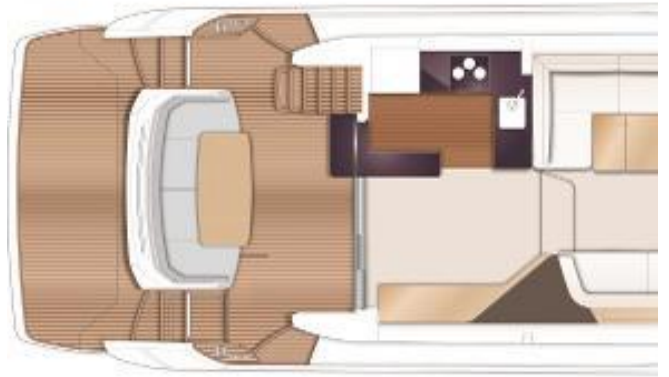
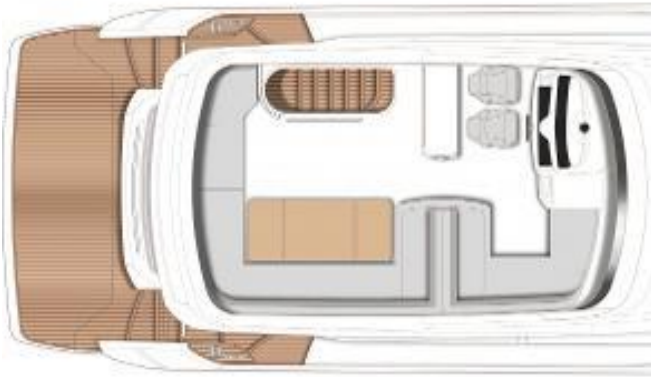

Princess F55 For Sale

Prince

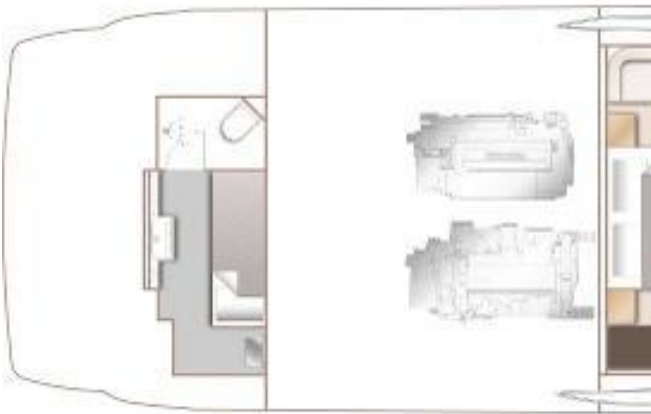

Princess F55 For Sale

FINANCE AND INSURANCE  
AVAILABLE ON THIS  
PRINCESS YACHT

Contact  
[finance@princess.co.uk](mailto:finance@princess.co.uk)  
[insurance@princess.co.uk](mailto:insurance@princess.co.uk)  
for information.



PRINCESS MOTOR YACHT SALES

