

PRINCESS X80 • 2024

Ref:PNX80031

CALL FOR PRICE



NEW 2024 PRINCESS X80 MOTOR YACHT - AVAILABLE NOW

OPEN TO PART EXCHANGE • PRINCESS TECHNICAL ORIENTATION INCLUDED

Twin MAN V12-1900 (2 x 1900 mhp each) diesel engines • 5 stateroom layout plus crew cabin fitout • Walnut interior wood, satin finish • Hydraulic bow and stern thruster • Wing station (third) controls • Sleiþner Hydraulic system • Two Kohler 28kW generators • Electric aft awning fitted to upper deck • Underwater lights • Upgraded exterior lighting package • Additional power sockets • Premium audio/video system

PLEASE CONTACT US FOR MORE INFORMATION ON THIS PRINCESS X80 MOTOR YACHTS FOR SALE

- Established over 40 years.
- Central agency for over 90 brokerage yachts for immediate delivery.
- Specialists in international delivery and the sourcing of yacht taxation advice.
- Access to the global Princess support network.

PRINCESS X80 SPECIFICATION

BUILDER/DESIGNER

Year: 2024
Construction: GRP

ENGINES

No. of Engines: 2
Make: Princess
Model: X80
Fuel Type: Diesel
Total Power: 3800 hp

ACCOMODATION

Cabins: 4
Heads: 4

DIMENSIONS

Length: 25.18 m / 83 ft 7 in
Beam: 6.06 m / 20 ft 10 in

TANKS

Water: 1 x 1500 l
Fuel: 1 x 7000 l

LOCATION

Swanwick, United Kingdom

INVENTORY

HULL COLOUR

- White hull

DECK EQUIPMENT

- Williams 395 SportJet Tender
- Skylounge coaming finished in Oyster Grey metallic paint
- Graphite Grey hardtop wrap around and ribbon/support legs finished in Oyster Grey metallic (radar mast and navigation equipment finished in non metallic dark grey)
- Wing station (third) controls in port side cockpit buttress (engine controls, emergency engine stops and thruster controls)
- Mooring package with leather fender saddles x 8
- Standard 6mm teak decking
- Primary anchor - 80kg stainless steel Ultramarine, with ultra-flip with swivel fitted and stemhead extension carriage with 150m of 14mm galvanised anchor chain

- Secondary anchor - 50kg stainless steel claw with 120m of 14mm galvanised anchor chain
- Electric aft awning fitted to upper deck (anthracite grey mesh)
- Plug in carbon pole transom shower and deck socket to bathing platform
- 2 x Seabob F5/F5 S/F5 SR storage and charging rack located in stern locker (does not include Seabob)
- Cool box accessed from flybridge foredeck walk-through area
- Main deck foredeck manual up/down dining/sunbed conversion with infill cushion
- Foredeck flybridge electrically operated sunpad/seat conversion in place of standard sunpad
- Flybridge powered convertible up/down dining/coffee table with folding leaves, in lieu of standard dining table
- Flybridge aft wet bar unit fitted with 90 litre drawer fridge
- Top loading cool box to aft end of flybridge dinette sofa
- Cockpit dining chairs (x3) - Kettal Net
- 90l drawer refrigerator for cockpit servery
- Exterior lighting upgrade package
- Underwater transom lights (4 x Lumishore THX 803 full colour, interfaced with Radar/Chartplotter MFD's)
- Underwater lighting to aft hull sides (4 x Lumishore THX803 full colour interfaced with radar/chartplotter MFD's, 2 per side)
- Reticulated foam fitted to all fixed exterior cockpit and foredeck seating/sunbeds
- Exterior covers in Grey
- Cockpit privacy screen

INTERIOR FITOUT

- Walnut interior wood, satin finish
- Misty/Carrara Quartz galley countertop
- Interior lighting upgrade package
- Main deck saloon floor in V-groove planked timber
- Saloon with large U-shaped sofa (includes additional cutlery, crockery & glasses service sets) with five free standing chair
- Saloon dining area with dinette sofa and powered folding up/down/inboard/outboard coffee/dining table to seat 10
- Hinged door to port side of main deck dinette/optional main deck master stateroom giving access to side deck/foredeck with opening porthole
- 2 x fixed bar stools in front of galley worktop/lifting screen
- Flip-up arm rests to helm seat (2)
- 5 stateroom layout with additional forward main deck master stateroom
- Main deck master stateroom/VIP with built in safe
- Lower deck master stateroom/VIP ensuite with combination bidet
- Port cabin has double berth conversion with powered sliding mechanism on inboard berth
- Electric roman blinds in lower deck master stateroom and all guest cabins
- Electric sheer roller blind in lower deck owners stateroom outboard of roman blind
- Electric roller blinds to all main deck living area windows (exc. day head) including galley, passageway and lower stateroom lobby
- Electric curtains to saloon aft patio doors
- Electric roller blinds to sky lounge
- Electric curtains to sky lounge aft patio door
- Heated towel rail in bathrooms x 4
- Additional combination washer/dryer located in guest lobby area
- Pilothouse navigator seat to starboard - includes flip-up arm rests (2)
- Crew mess in lieu of standard aft port cabin berth, incorporating kitchenette, breakfast bar and 2 bar stools.
- Crew cabin fitout with additional single bunk in starboard crew cabin in place of storage

INTERIOR EQUIPMENT

- Additional Sub-Zero drawer unit in galley: 2 x 56.5l fridge drawer (in addition to standard 295l fridge & 2 x 47.5l freezer drawers)
- Crew kitchenette is equipped with 2-zone hob, convection microwave oven, under counter fridge/freezer and mixer tap/sink

PRINCESS X80

INVENTORY

AUDIO VISUAL AND COMMUNICATIONS EQUIPMENT

- Premium audio/visual system
- Deck Saloon - 55" LED TV on a power lift paired with upgraded Focal speakers (4) and a subwoofer
- Owner's Stateroom - 55" LED TV, Naim Uniti Atom audio system with Bluetooth, multi-zone streaming capability and dedicated app. paired with upgraded Focal speakers (2) and a subwoofer
- Forward Stateroom - 43" LED TV, Naim Uniti Atom audio system with Bluetooth, multi-zone streaming capability and dedicated app. paired with upgraded Focal speakers (2) and a subwoofer
- Starboard guest cabin - 32" magic mirror HD LED TV, Naim Uniti Atom audio system with Bluetooth, multi-zone streaming capability and dedicated app. paired with upgraded Focal speakers (2)
- Port guest cabin - 32" LED TV, Naim Uniti Atom audio system with Bluetooth, multi-zone streaming capability and dedicated app. paired with upgraded Focal speakers (2)
- Forward dining area/main deck master stateroom 50" LED TV multi-zone streaming capability and dedicated app. Paired with JL Audio waterproof speakers (4) and a subwoofer and amplifier
- Skylounge 55" LED TV, Naim Uniti Star audio system with Bluetooth, multi-zone streaming capability and dedicated app. Paired with upgraded Focal speakers (4) and a subwoofer
- Flybridge Aft - Naim Uniti Star audio system with Bluetooth multi-zone streaming capability and dedicated app. Paired with JL Audio waterproof speakers (4) a subwoofer and an amplifier
- Flybridge Foredeck - Naim Uniti Atom audio system with Bluetooth multi-zone streaming capability and dedicated app. Paired with JL Audio M6-650X-L waterproof speakers (2)
- Cockpit seating area - Naim audio Uniti Atom system with Bluetooth, multi-zone streaming capability and dedicated app. Paired with JL Audio waterproof speakers (2) and a subwoofer and amplifier.
- Foredeck seating walk-through area - Naim Uniti Atom audio system with Bluetooth, multi-zone streaming capability and dedicated app. Paired with JL Audio waterproof speakers (2)
- System includes:
 - On board Ethernet network and 4G/5G internet capability
 - On board WIFI network incorporating external WIFI and 3G/4G antenna for extended range. Enabling connectivity to onshore WIFI networks throughout the vessel including crew and external guest areas. (Mobile internet connectivity requires an activated mobile data SIM card.)
 - System is plug and play with external devices via HDMI/USB socket panel
 - 256GB SD card

SHIP'S SYSTEMS

- Two Kohler 28kW/50Hz generators
- Reverse cycle air-conditioning/heating - suitable for temperatures to 50°C (Gulf spec) incorporating a windscreen demist facility
- Hydraulic stern thruster (320kgF)
- Sleipner Hydraulic system
- Multi sockets throughout craft
- Additional power sockets fitted to skylounge, deck saloon, galley, forward dining/main deck master option and all cabins, including crew quarters
- Qi wireless chargers on flybridge foredeck and main deck foredeck seating
- AGM 90Ah batteries (for start, domestic and generator batteries)
- Spot Zero combined watermaker and water purification system (190l/hr)
- 2 x fixed CCTV cameras in engine room
- Top shore locker - 1 shoreline will be 125 amp 3 phase
- Lower shore locker - 2 x 63amp single phase
- Combination inverter charger fitted, providing seamless transfer between generators/shore power and inverted battery power for full audio and wi-fi system
- Grey water tank (1,400 litres), in addition to black water tank
- Princess Connect telemetry and maintenance system

PRINCESS X80

INVENTORY

NAVIGATION EQUIPMENT

- 2 x Raymarine Axiom XL multifunction 19" brilliant colour multifunction displays at helm
- Additional Raymarine Axiom XL multifunction 19" brilliant colour multifunction display at helm with connection to the RMK-10 remote control keypad
- Raymarine AIS Class B transponder interfaced with chartplotters
- European Version Plotter Charts
- International VHF

DISCLAIMER

The Vendor is selling in the course of a business. Whilst every care has been taken in their preparation, the correctness of these particulars is not guaranteed. The particulars are intended only as a guide and they do not constitute a term of any contract. A prospective buyer is strongly advised to check the particulars and where appropriate at his own expense to employ a qualified Marine Surveyor to carry out a survey and/or to have an engine trial conducted which if conducted by us shall not imply any liability for such engine on our part.

PRINCESS X80 PHOTOS



Princess X80031 For Sale



Princess X80031 For Sale

PRINCESS X80 PHOTOS



Princess X80031 For Sale



Princess X80031 For Sale

PRINCESS X80 PHOTOS



Princess X80031 For Sale



Princess X80031 For Sale



Princess X80031 For Sale



Princess X80031 For Sale



Princess X80031 For Sale



Princess X80031 For Sale



Princess X80031 For Sale



Princess X80031 For Sale



Princess X80031 For Sale



Princess X80031 For Sale



Princess X80031 For Sale



Princess X80031 For Sale



Princess X80031 For Sale



Princess X80031 For Sale



Princess X80031 For Sale



Princess X80031 For Sale



Princess X80031 For Sale



Princess X80031 For Sale



Princess X80031 For Sale



Princess X80031 For Sale



Princess X80031 For Sale



Princess X80031 For Sale



Princess X80031 For Sale



Princess X80031 For Sale



Princess X80031 For Sale



Princess X80031 For Sale



Princess X80031 For Sale



Princess X80031 For Sale



Princess X80031 For Sale



Princess X80031 For Sale



Princess X80031 For Sale



Princess X80031 For Sale



Princess X80031 For Sale



Princess X80031 For Sale



Princess X80031 For Sale



Princess X80031 For Sale



Princess X80031 For Sale



Princess X80031 For Sale



Princess X80031 For Sale



Princess X80031 For Sale



Princess X80031 For Sale



Princess X80031 For Sale



Princess X80031 For Sale



Princess X80031 For Sale



Princess X80031 For Sale



Princess X80031 For Sale



Princess X80031 For Sale



Princess X80031 For Sale



Princess X80031 For Sale



X80 Flybridge - standard

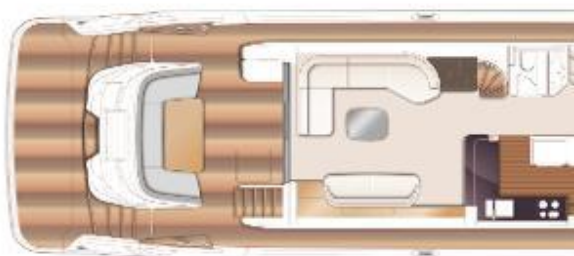

X80 Main Deck - standard

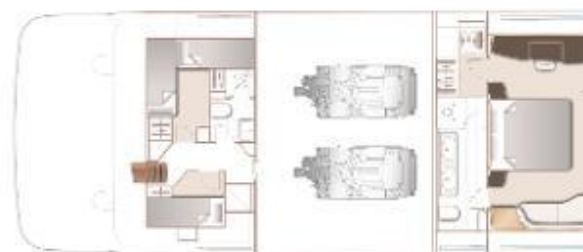

X80 Lower Deck - standard

FINANCE AND INSURANCE
AVAILABLE ON THIS
PRINCESS YACHT

Contact
finance@princess.co.uk
insurance@princess.co.uk
for information.

PRINCESS
OFFICIAL DISTRIBUTOR
UK / SPAIN / GERMANY
NETHERLANDS / ITALY
PRINCESS MOTOR YACHT SALES

