

PRINCESS F55 • 2020

Ref:PB2307

PRICE: £1,650,000 INC VAT



OPEN TO PART EXCHANGE • PRINCESS TECHNICAL ORIENTATION INCLUDED

PROFESSIONAL PHOTOGRAPHY AND VIRTUAL TOUR AVAILABLE

Twin Volvo D13-900 diesel engines • White hull • Walnut interior wood, satin finish • Teak laid decks • Onan 17.5kW generator upgrade • Reverse cycle air-conditioning/heating • Seakeeper gyro • Volvo joystick control • Electro-hydraulic powered bimini top • Exterior lighting upgrade • BBQ fitted in wetbar • Underwater transom lights • LED TV'S • Cockpit waterproof speakers • New all over flybridge cover • Serviced annually by Princess Motor Yachts since new
PLEASE CONTACT US FOR MORE INFORMATION ON THIS PRINCESS F55 FLYBRIDGE MOTOR YACHT FOR SALE

- Established over 40 years.
- Central agency for over 90 brokerage yachts for immediate delivery.
- Specialists in international delivery and the sourcing of yacht taxation advice.
- Access to the global Princess support network.

PRINCESS F55 SPECIFICATION

BUILDER/DESIGNER

Year: 2020
Construction: GRP

ENGINES

No. of Engines: 2
Make: Volvo
Model: D13-900
Fuel Type: Diesel
Hours: 247
Total Power: 1800 hp

ACCOMODATION

Cabins: 3
Heads: 2

DIMENSIONS

Length: 17.65 m / 58 ft 10 in
Beam: 4.88 m / 16 ft 0 in

TANKS

Water: 1 x 507 l
Fuel: 1 x 2290 l

LOCATION

Hythe, United Kingdom

INVENTORY

HULL COLOUR

- White Hull

DECK EQUIPMENT

- Teak laid side decks, foredeck, coachroof walkthrough and flybridge deck
- All outside seating cushions upgraded to closed cell foam (cuddy and fly bridge)
- Electro-hydraulic transom platform with raise/lower facility (450Kg SWL) with keyway plates and slider system to enable the later fitting of dinghy chocks
- Electro hydraulically powered Bimini top includes LED overhead dimmable lighting (switched from console)
- Exterior lighting upgrade package includes low level accent strip lights below flybridge wetbar, accent spots on

transom, additional 7 deck lights to side deck and foredeck area, pop up lanterns to flybridge forward dinette

- Electric stern rope handling winches (2)
- Lava brick BBQ fitted to flybridge wetbar
- Foredeck freshwater anchor / deck wash system
- Stainless steel anchor
- Upgraded gypsy for 12mm chain and 80m of new chain installed
- Quick chain counter with remote
- Garmin rear facing docking camera
- Bimini includes lights along with pop up lights on the flybridge
- Underwater transom lights (4 Lumishore SMX53 White)
- Stern docking lights
- Foredeck sunbed cushion (with adjustable headrest) in Comfort Exterior III Met Macadamia with Vogue
- Cockpit, flybridge and foredeck seating with contrast panelling to backrests in Comfort Exterior III Met Macadamia Contrast: Vogue Earth
- Reticulated foam for foredeck sunbeds
- Exterior covers - Grey Canvas
- Bimini top - Grey canvas
- Fender socks - Grey with Princess logo x 6
- 6 additional fenders with socks (Total 12)

NAVIGATION EQUIPMENT

- Volvo joystick control (dual station) with low speed manoeuvring in 'docking mode' and steering at any speed in 'driving mode'
- Hold function docking facility, includes fitting 170kgf variable speed stern thruster
- Garmin XHD colour radar with 24", 4Kw Radome (with display on standard 16" screen which allows separate or split displays with standard chartplotter and engine instrumentation)
- Second 16" colour multifunction display fitted at lower helm position
- Second 16" colour multifunction display fitted at the upper helm
- Garmin AIS 800 Class B transponder
- International VHF

SHIPS SYSTEMS

- Onan 17.5kW generator upgrade from standard
- Seakeeper 9
- UK 220V/240V Sockets
- Air-conditioning/heating reverse cycle (78,000BTU) suitable for temperatures to 40C (tropical), with controls in all cabins and outlets in all areas (including bathrooms)
- Windscreen demist system using warm air heater powered from calorifier
- Sea Keeper Gyro
- Electric overboard discharge system in addition to standard manual system (as well as the electric pump an electrically operated valve is fitted in the discharge line so that the seacock does not need to be operated every time the system is used)
- Seacock fitted with a micro switch so that the pump cannot operate when the seacock is closed
- Engine room 1x double waterproof socket
- Galley Additional 6 sockets in galley
- Additional double socket in lower helm
- Additional double socket either side of bed in master stateroom
- Installed 3000 watt inverter plumbed to a 240V galley plug using additional gel batteries and separate/ additional shore charger to replenish those batteries. Tea or coffee can thus be made without having to run a noisy generator at anchor

PRINCESS F55

INVENTORY

INTERIOR FITOUT

- Walnut interior wood satin finish
- Galley worktops are Sylmar white solid surface to match the bar top
- Aft cabin fit out (single berth with separate WC and shower)
- Electronic remote dimmer for lights in guest cabins
- Extra mood lighting in main guest cabin
- All sleeping cabins include upgraded special bedheads
- Saloon full size dining/coffee table with twin electrically operated leg mechanisms. Table reduces in length by 50% when folded and has a sliding mechanism to allow for use as a coffee table
- Starboard cabin includes double berth conversion with powered sliding mechanism on inboard berth
- Aft cabin toilet connected into the the holding tank system

INTERIOR EQUIPMENT

- Nespresso coffee maker
- Dishwasher fitted in galley (slimline, 9 place setting)
- Icemaker fitted in aft Saloon
- Heated towel rail in master stateroom bathroom
- Combination washing machine/dryer (fitted below companionway stairs)
- Mosquito screens for all opening portlights
- Princess China (5 piece, 6 place settings)
- Princess Glasses (6 wine, 6 tumblers)
- David Mellor 'Paris' Cutlery (7 pieces 6 place settings)

AUDIO VISUAL EQUIPMENT

- Deck Saloon - Fusion Apollo RA-770 with Wifi/DAB & external USB, Samsung BD-J5900 Blu-ray player and 4 Fusion signature 7.7" speakers (when optional TV is selected (in place of Fusion MS-AV755
- Master Stateroom - Fusion Apollo RA-770 with Wifi/DAB, Samsung BD-J5900 Blu-ray player and 4 Fusion signature 6" speakers (when optional TV is selected) in place of Fusion MS-AV755
- Cockpit - 2 waterproof Fusion signature 7.7" speakers linked to saloon audio unit with local control (Fusion NRX-300) and amp
- Flybridge - Fusion SRX-400 Radio/Wifi/Bluetooth with Fusion waterproof 6.5" speakers linked to saloon audio unit
- Master Stateroom - 40" UHD LED TV with Fusion MS-AV755 Radio/DVD/MP3 player with Bluetooth facility in place of Fusion SRX-400
- Forward stateroom - 32" HD LED TV with Fusion MS-AV755 Radio/DVD/MP3 player with Bluetooth
- Starboard Cabin - 28" HD LED TV with Fusion MS-AV755 Radio/DVD/MP3 player with Bluetooth
- WiFi extender hardwired to installed windows computer that uses the main TV as a monitor; on board access point for guests and USB for owner's laptop to us as an alternative to the TV

OWNER COMMENTS

- Professionally serviced annually by Princess Motor Yachts since new
- Spare engine filters and spare anodes, including for the Seakeeper available
- One set of princess towels and bed linen

PRINCESS F55 INVENTORY

DISCLAIMER

In this case we are acting as Brokers only.

The Vendor is not selling in the course of a business. Whilst every care has been taken in their preparation, the correctness of these particulars is not guaranteed. The particulars are intended only as a guide and they do not constitute a term of any contract. A prospective buyer is strongly advised to check the particulars and where appropriate at his own expense to employ a qualified Marine Surveyor to carry out a survey and/or to have an engine trial conducted which if conducted by us shall not imply any liability for such engine on our part.

PRINCESS F55 PHOTOS

PRINCESS
BROKERAGE INTERNATIONAL

EST 1964

OUR KNOWLEDGE IS YOUR LUXURY

> OPEN TO PART EXCHANGE

WE CAN HELP SPEED UP THE SALE THROUGH OUR OFFER TO UNDERWRITE A PART-EXCHANGE AGAINST THE BROKERAGE YACHT

> PRINCESS TECHNICAL ORIENTATION INCLUDED

AT NO ADDITIONAL COST, REGARDLESS OF WHERE THIS YACHT IS LOCATED, WE OFFER A COMPREHENSIVE TECHNICAL INTRODUCTION TO YOUR PURCHASE

> PROFESSIONAL PHOTOGRAPHY, VIDEO & 3D TOUR AVAILABLE

VIEW IMAGERY, VIDEO AND A 3D TOUR/WALKTHROUGH OF THIS YACHT ONLINE



PRINCESS
BROKERAGE INTERNATIONAL

brokerage@princess.co.uk

+44 (0)1489 557755

www.princessmotoryachtsales.com



Princess F55 For Sale

PRINCESS F55 PHOTOS



Princess F55 For Sale



Princess F55 For Sale

PRINCESS F55 PHOTOS



Princess F55 For Sale



Princess F55 For Sale



Princess F55 For Sale



Princess F55 For Sale



Princess F55 For Sale



Princess F55 For Sale



Princess F55 For Sale



Princess F55 For Sale



Princess F55 For Sale



Princess F55 For Sale



Princess F55 For Sale



Princess F55 For Sale



Princess F55 For Sale



Princess F55 For Sale



Princess F55 For Sale



Princess F55 For Sale



Princess F55 For Sale



Princess F55 For Sale



Princess F55 For Sale



Princess F55 For Sale



Princess F55 For Sale



Princess F55 For Sale



Princess F55 For Sale



Princess F55 For Sale



Princess F55 For Sale



Princess F55 For Sale



Princess F55 For Sale



Princess F55 For Sale



Princess F55 For Sale



Princess F55 For Sale



Princess F55 For Sale



Princess F55 For Sale



Princess F55 For Sale



Princess F55 For Sale



Princess F55 For Sale



Princess F55 For Sale



Princess F55 For Sale



Princess F55 For Sale



Princess F55 For Sale



Princess F55 For Sale



Princess F55 For Sale



Princess F55 For Sale

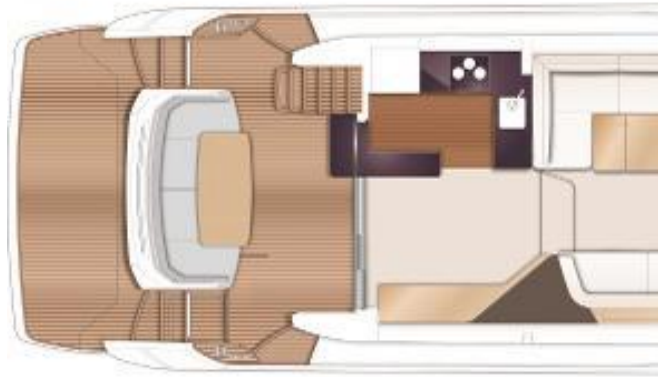
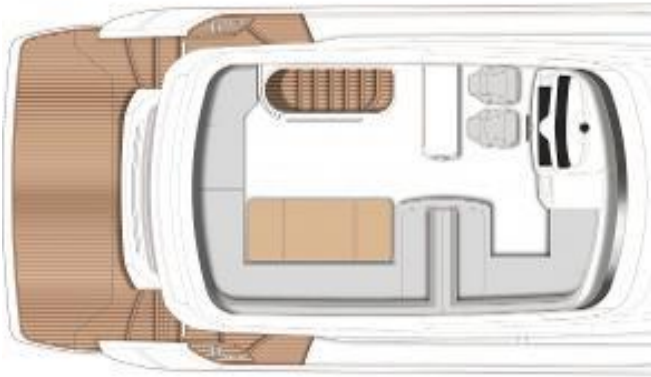

Manufacturer Provided Image: Princess 55 Flybridge Layout Plan

Prince

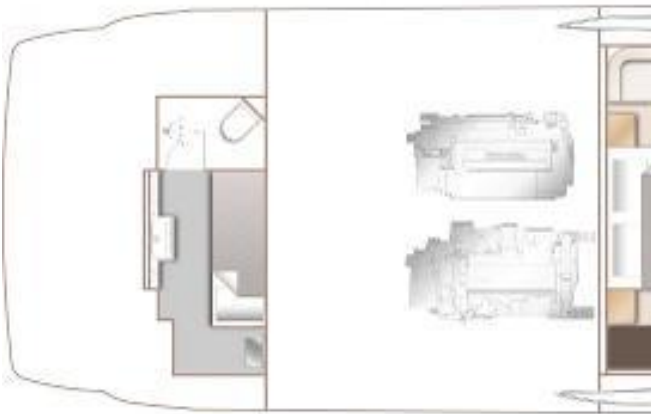

Princess F55 Lower Deck Layout Plan

FINANCE AND INSURANCE
AVAILABLE ON THIS
PRINCESS YACHT

Contact
finance@princess.co.uk
insurance@princess.co.uk
for information.



PRINCESS MOTOR YACHT SALES

